

CONSTRUCTION SPECIFICATIONS
1. WOVEN WIRE FENCE TO BE FASTENED SECURELY TO FENCE POSTS WITH WIRE OR STAPLES. POSTS SHALL BE STEEL EITHER 1" OR 1 1/2" TYPE OR HARDWOOD.

CONSTRUCTION SPECIFICATIONS
1. STONE SIZE - USE #2 STONE, OR RECLAIMED OR RECYCLED CONCRETE EQUIVALENT. LENGTH NOT LESS THAN 50 PERCENT ON A SINGLE RESIDENCE LOT WHERE A 30 FOOT MINIMUM LENGTH WOULD APPLY.

CONSTRUCTION SPECIFICATIONS
1. ALL GRADED OR DISTURBED AREAS INCLUDING SLOPES SHALL BE PROTECTED DURING CLEANING AND CONSTRUCTION IN ACCORDANCE WITH THE APPROVED SEDIMENT CONTROL PLAN...

LANDGRADING SPECIFICATIONS
1. ALL GRADING SHALL BE TO THE PROVISIONS OF THIS STANDARD AND SPECIFICATION.

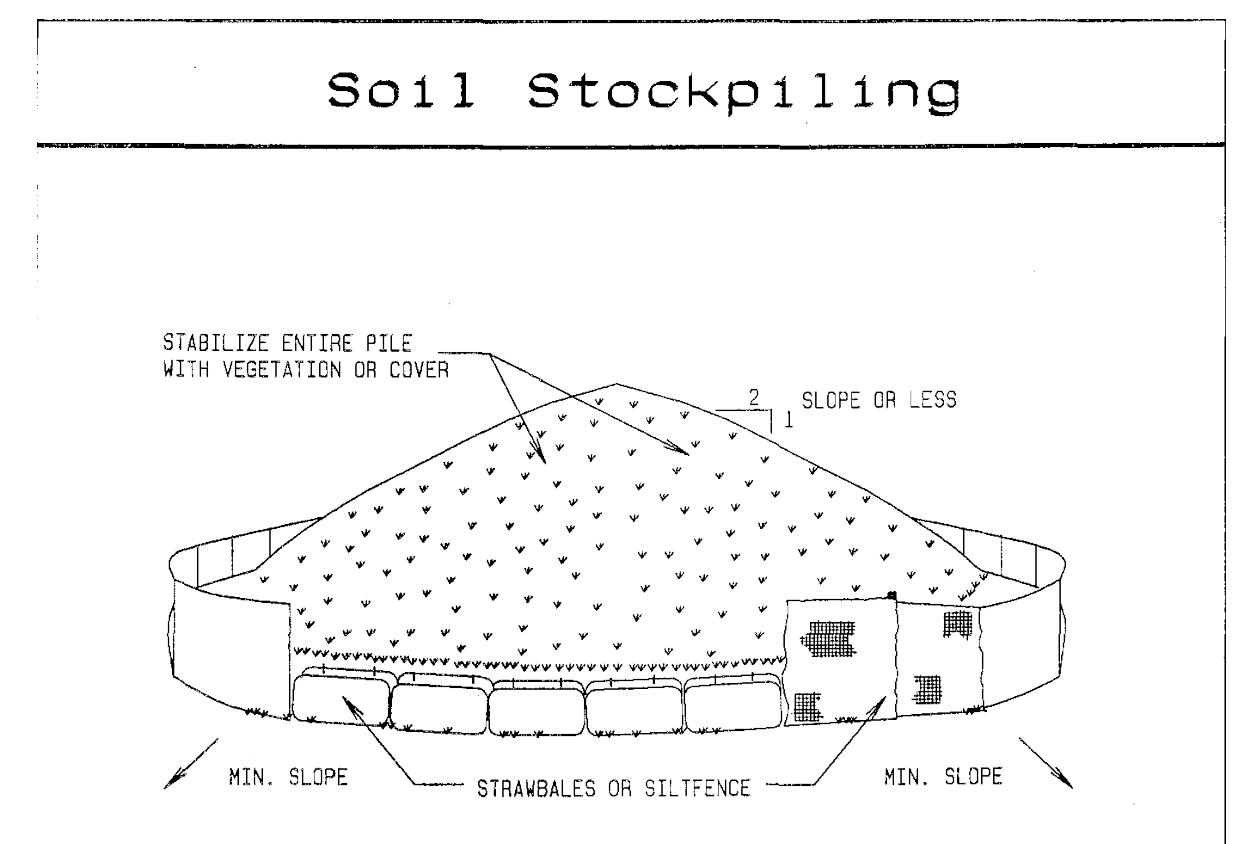

INSTALLATION NOTES
1. AREA CHOSEN FOR STOCKPILING OPERATIONS SHALL BE DRY AND STABLE.
2. MAXIMUM SLOPE OF STOCKPILE SHALL BE 1:2.

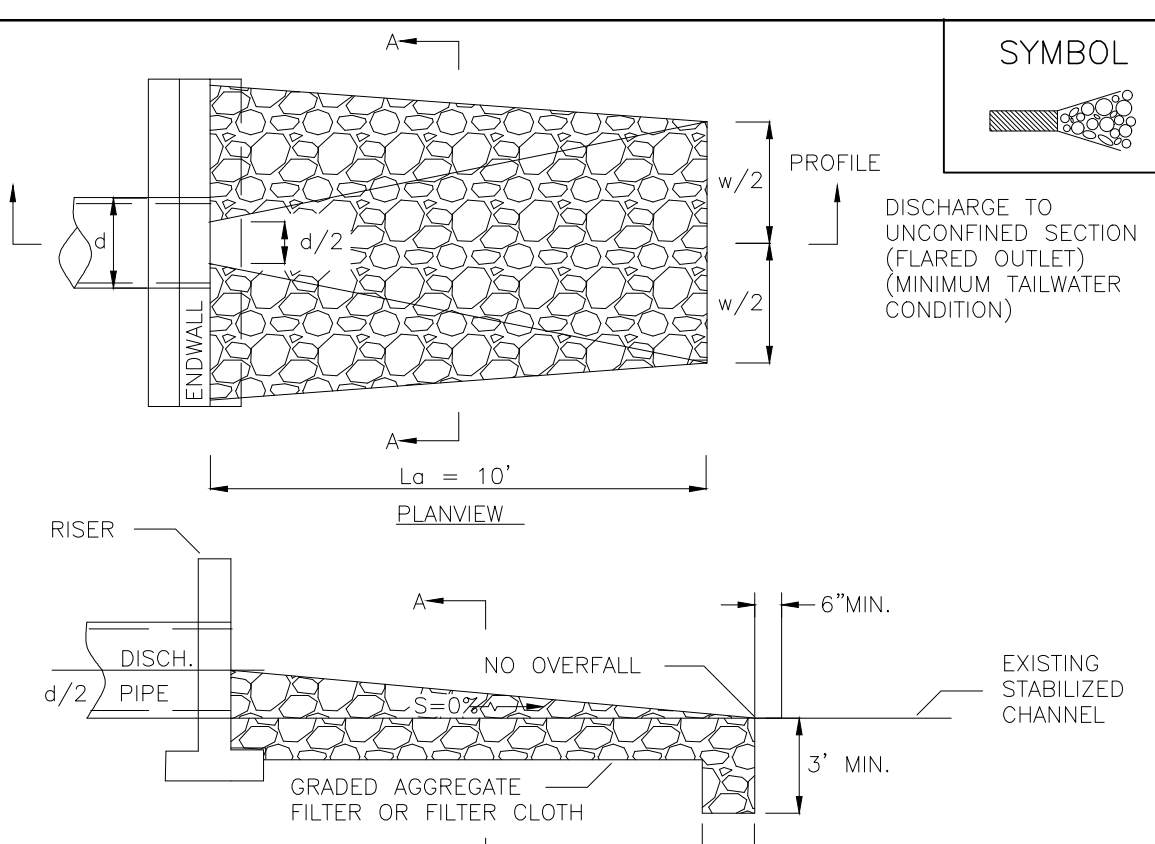

RIPRAP OUTLET PROTECTION
1. THE DEPARTMENT OF AGRICULTURE, NATURAL RESOURCES CONSERVATION SERVICE, NEW YORK STATE DEPARTMENT OF ENVIRONMENTAL CONSERVATION, NEW YORK STATE SOIL & WATER CONSERVATION COMMITTEE.

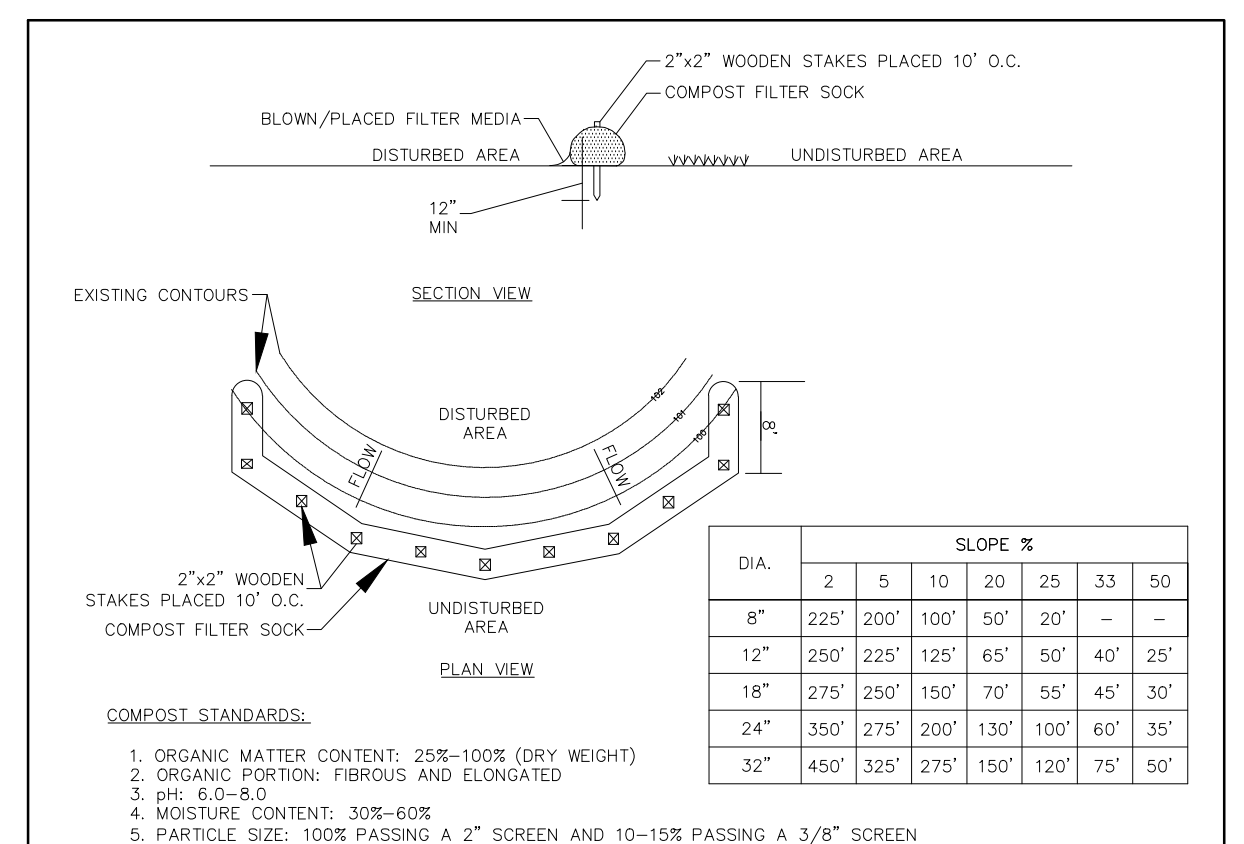
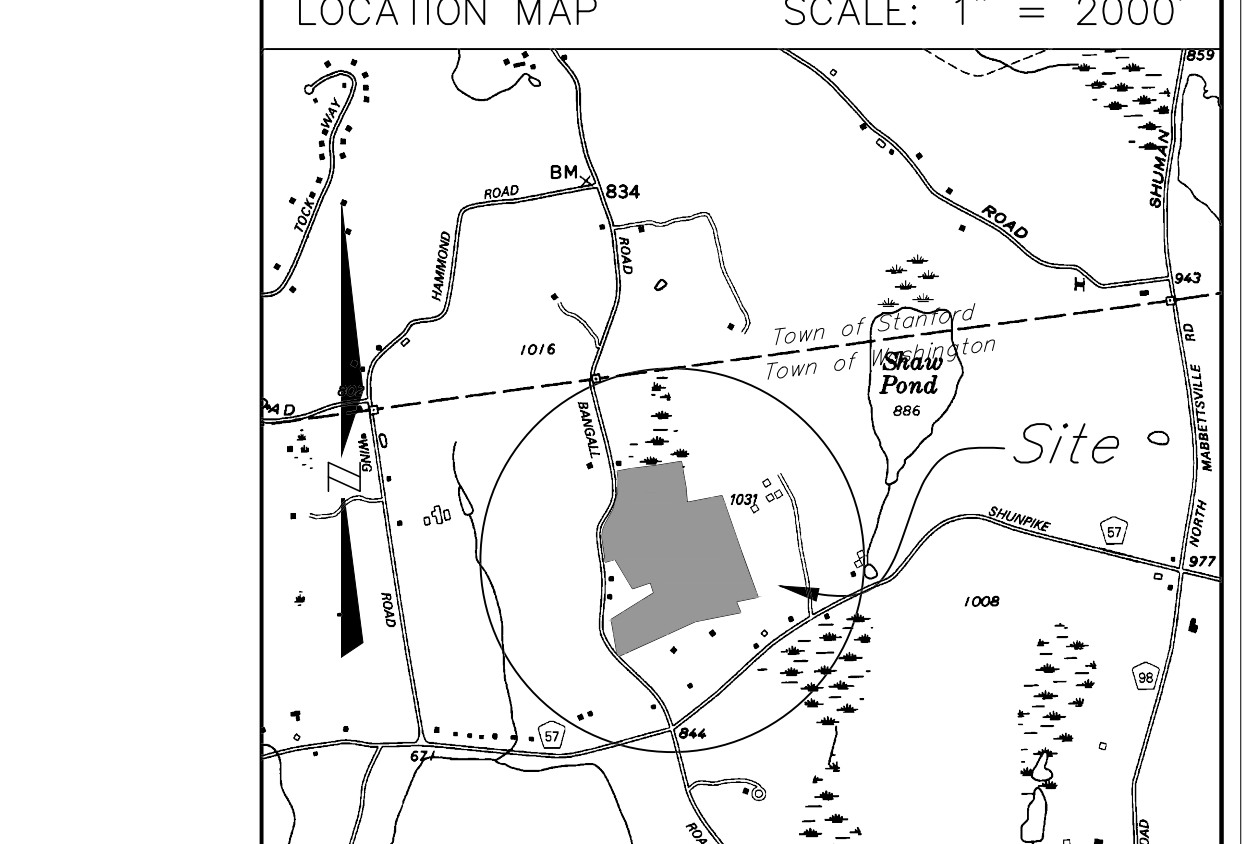

Table with columns: MATERIAL TYPE, 3 MIL HOPE, 3 MIL HOPE, 3 MIL HOPE, MULTI-LAYERED POLYPROPYLENE FIBERGLASS REINFORCED (MFRP), HEAVY-DUTY POLYPROPYLENE FIBERGLASS REINFORCED (HDFR).



SITE DATA
TAX MAP NO.: 135889-6767-00-06050
LOT AREA: 45.3 ACRES
ZONING DISTRICT: RS-10; RURAL RESIDENTIAL

EROSION & SEDIMENT CONTROL NOTES
1. PRIOR TO THE START OF CONSTRUCTION ACTIVITY, THE TEMPORARY STRUCTURAL SEDIMENT CONTROL (SILT FENCE, STABILIZED CONSTRUCTION ENTRANCE, ETC.) FOR THE ANTICIPATED WORK MUST BE INSTALLED.

GOOD HOUSEKEEPING
1. ALL WASTEWATER MATERIAL WILL BE COLLECTED AND STORED IN A SECURELY LABELED DUMPSTER SUPPLIED BY A WASTE HANDLER THAT IS A LICENSED SOLID WASTE METAL...

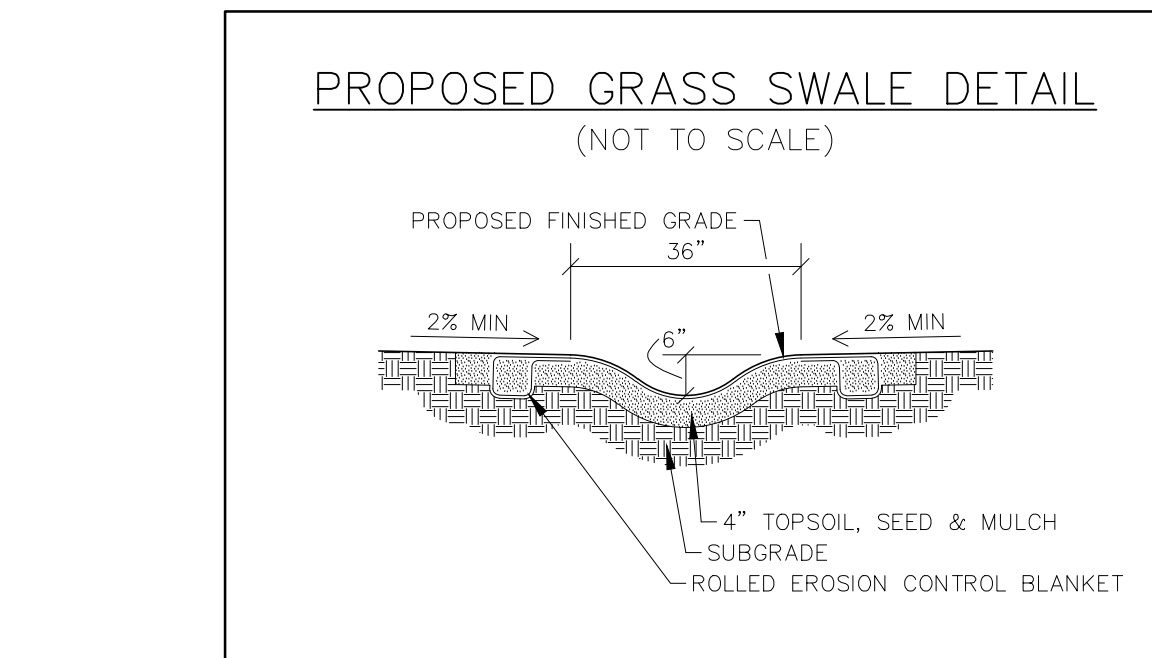

UNDERGROUND WARNING - NYS CODE RULE 753
NEW YORK STATE INDUSTRIAL CODE 53 REQUIRES EXCAVATORS TO CALL (914) 490-8200...

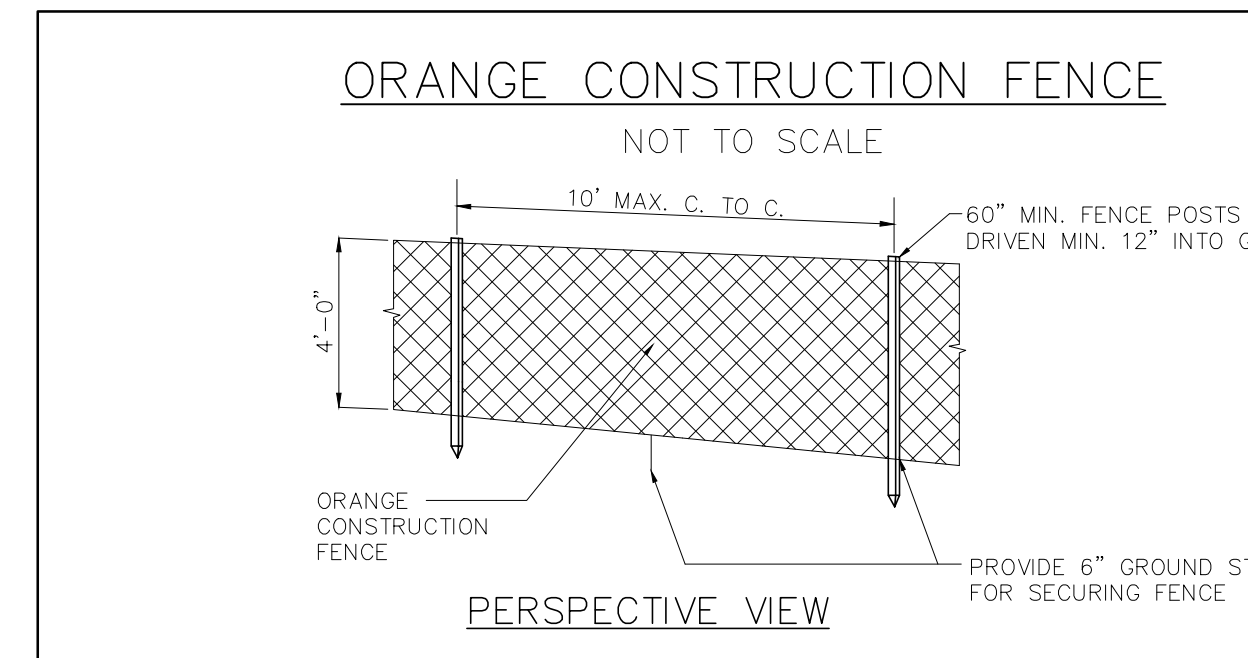

SECTION
60" MIN. FENCE POST
12" MIN. UNDISTURBED GROUND

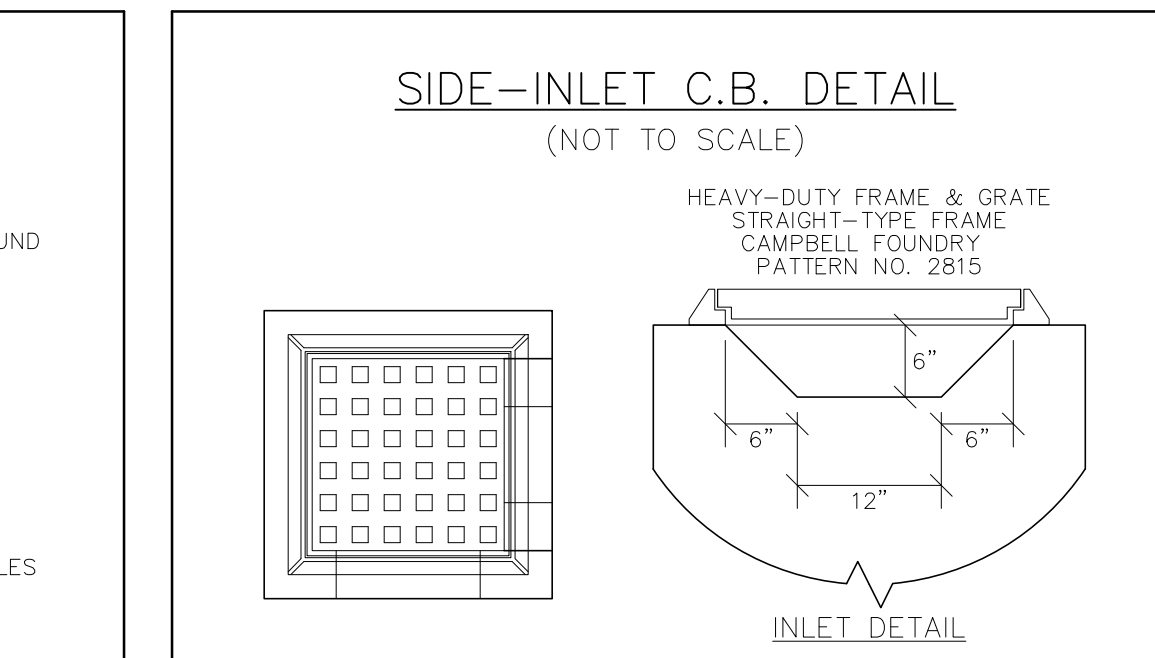

NOTES:
1. CONCRETE TO TEST 4,000 PSI @ 28 DAYS IN CONFORMANCE WITH ASTM C-478-68.

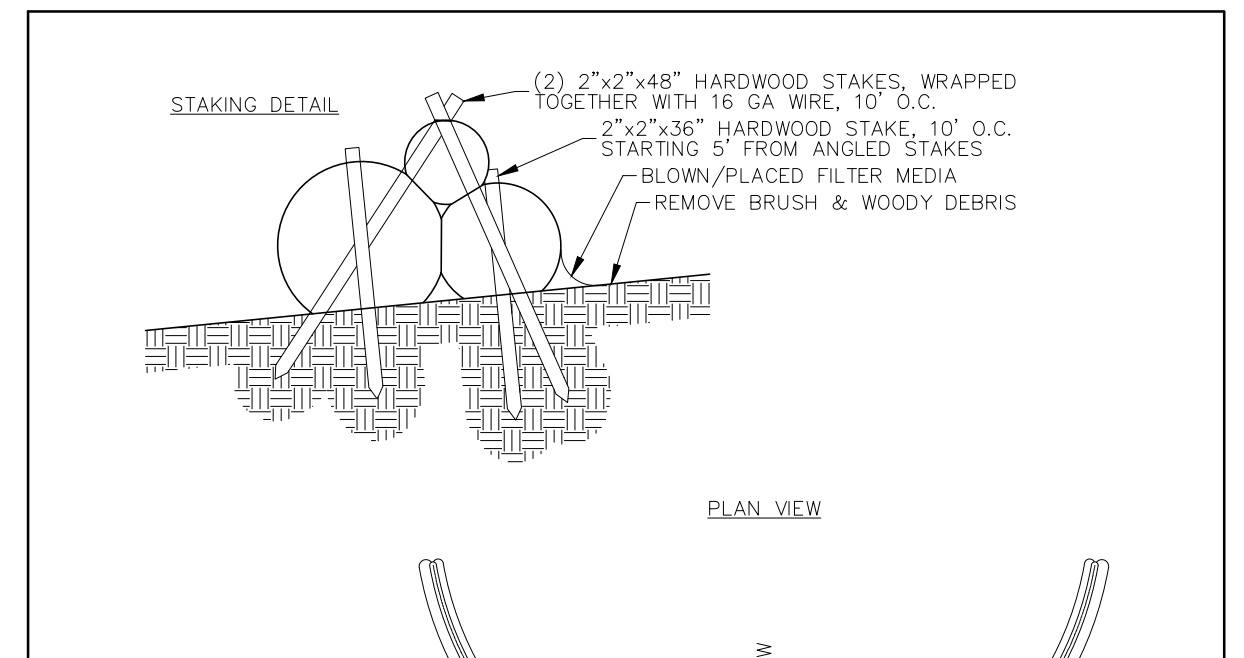

NOTES:
1. SOOK FABRIC MATERIAL AND DUMPSTER SHALL MEET THE STANDARDS LISTED IN THE COMPOST FILTER SOCK DETAIL.

CONSTRUCTION SPECIFICATIONS
1. CONDUCT PRE-CONSTRUCTION CONFERENCE WITH OWNER, CONTRACTOR, AND REPRESENTATIVES OF THE TOWN OF PHILISTOWN AND INVOLVED AGENCIES.



CONSTRUCTION SPECIFICATIONS
1. LAY ONE BLOCK ON EACH SIDE OF THE STRUCTURE ON ITS SIDE FOR DEMATERING. FOUNDATION SHALL BE 2 INCHES MINIMUM BELOW REST OF INLET AND BLOCKS SHALL BE PLACED AGAINST INLET FOR SUPPORT.

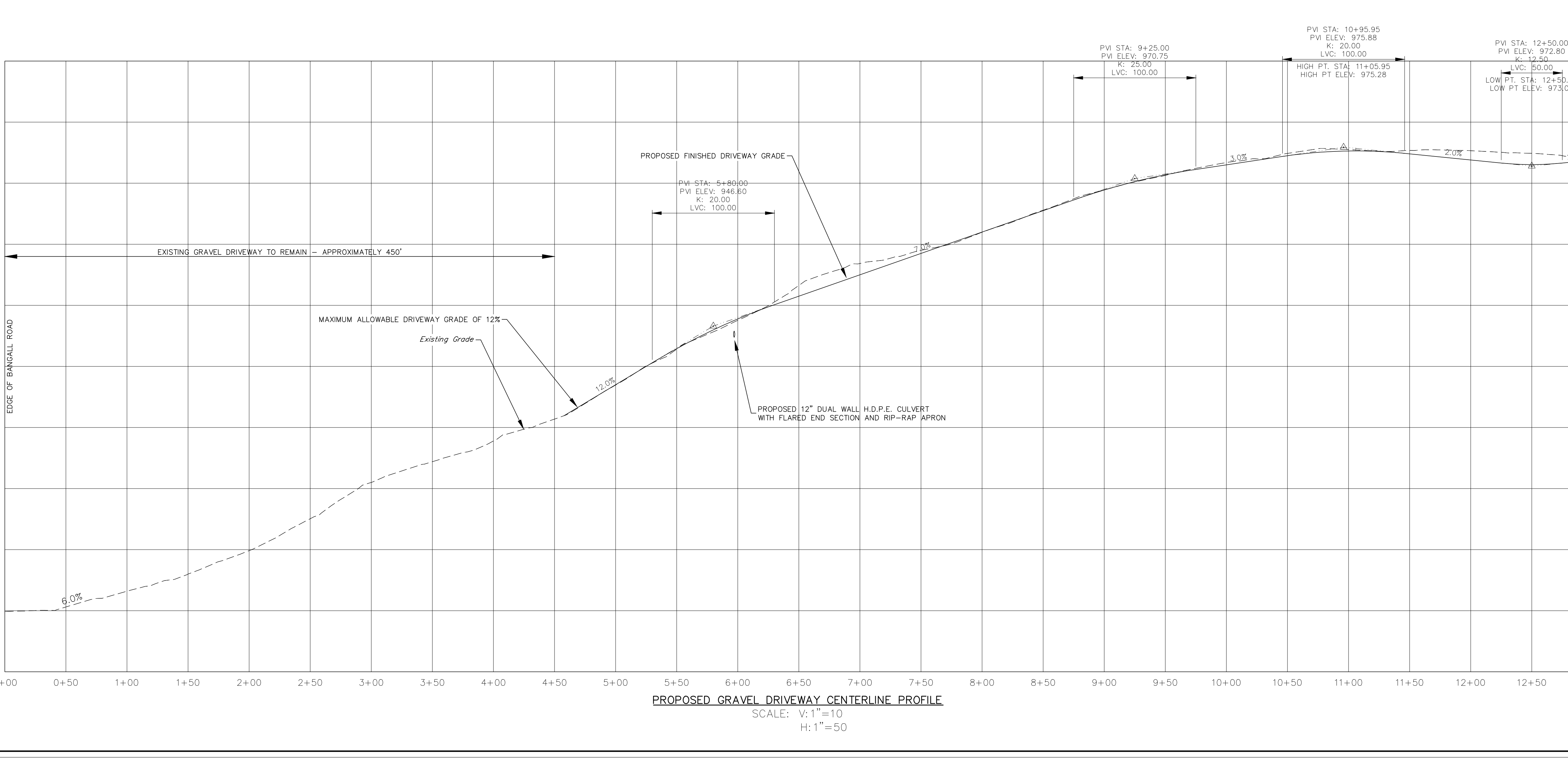

MAP NOTES
1. Property line bearings and distances shown herein are taken from "Map of Survey for The Lots of Jesse Derris & Jordana Kier..."

SOILS LEGEND
Map Symbol, Hydraulic Group, Soil Name
DwD B/D DUTCHESS-CARDIAN complex, hilly, rocky

REVISIONS
DATE, DESCRIPTION
10/22/20 ORIGINAL DRAWING

WARNING STAMP
ALTERATION OF THIS DOCUMENT IN ANY WAY, BY ANY PERSON NOT UNDER THE DIRECTION OF A LICENSED PROFESSIONAL ENGINEER OR LAND SURVEYOR AS APPROPRIATE, IS A VIOLATION OF THE EDUCATION LAW OF THE STATE OF NEW YORK.

PROJECT LOCATION
692-696 BANGALL ROAD, MILLBROOK TOWN OF WASHINGTON COUNTY OF DUTCHESS STATE OF NEW YORK

PROJECT DESCRIPTION
NEW CONSTRUCTION OF SINGLE-FAMILY RESIDENCE TO BE SERVED BY NEW INDIVIDUAL PRIVATE SEPTIC & WELL. THIS RESIDENCE SHALL BE THE PRIMARY HOME AND THE EXISTING RESIDENCE SHALL BE THE GUEST HOUSE.

CONSTRUCTION NOTES & DETAILS
STORMWATER POLLUTION PREVENTION PLAN (BASIC)

PRINTED April 20, 2021
BADEY & WATSON
3063 Route 9, Catskill, NY 12016, 845.263.9217
www.Badey-Watson.com

DRAWING NAME: SD25163_R04_V17 CHECKED BY: MSM DRAWN BY: JRS LAYOUT: DETAIL W.O. NO. 25163 SHEET 3 OF 3