

LEGEND

- PROPOSED SILENT FENCE
- PROPOSED COMPOST FILTER SOCK
- TEMPORARY STABILIZED CONSTRUCTION ACCESS TO LOT OR SWANELL
- PROPOSED LIMIT OF DISTURBANCE
- EXISTING GUTTER DOWNSPOUT
- PROPOSED SPOT GRADE
- EXISTING SPOT GRADE
- PROPOSED MAJOR CONTOUR ELEVATION
- PROPOSED MINOR CONTOUR ELEVATION
- DEEP HOLE TEST PIT W/ DESIGNATION
- PERCOLATION TEST HOLE W/ DESIGNATION

WETLANDS LEGEND

- FEDERAL (NW) WETLANDS BOUNDARY
- FRESHWATER FORESTED/SHRUB WETLAND
- FEDERAL (NW) WETLANDS BOUNDARY
- FRESHWATER POND
- STATE-REGULATED (RES) FRESHWATER WETLAND BOUNDARY
- MUSKOG WETLAND ID: MB-16
- SOIL SURVEY DETERMINATION (SSA)
- HYDRIC SOILS (TOWNSHIP-REGULATED)
- ADJACENT AREA (STATE 100' BUFFER)
- CONTROLLED AREA (TOWN 100' BUFFER)
- FEDERAL WETLANDS HAVE NO REGULATED BUFFER
- COMBINED STATE/TOWN 100' BUFFER

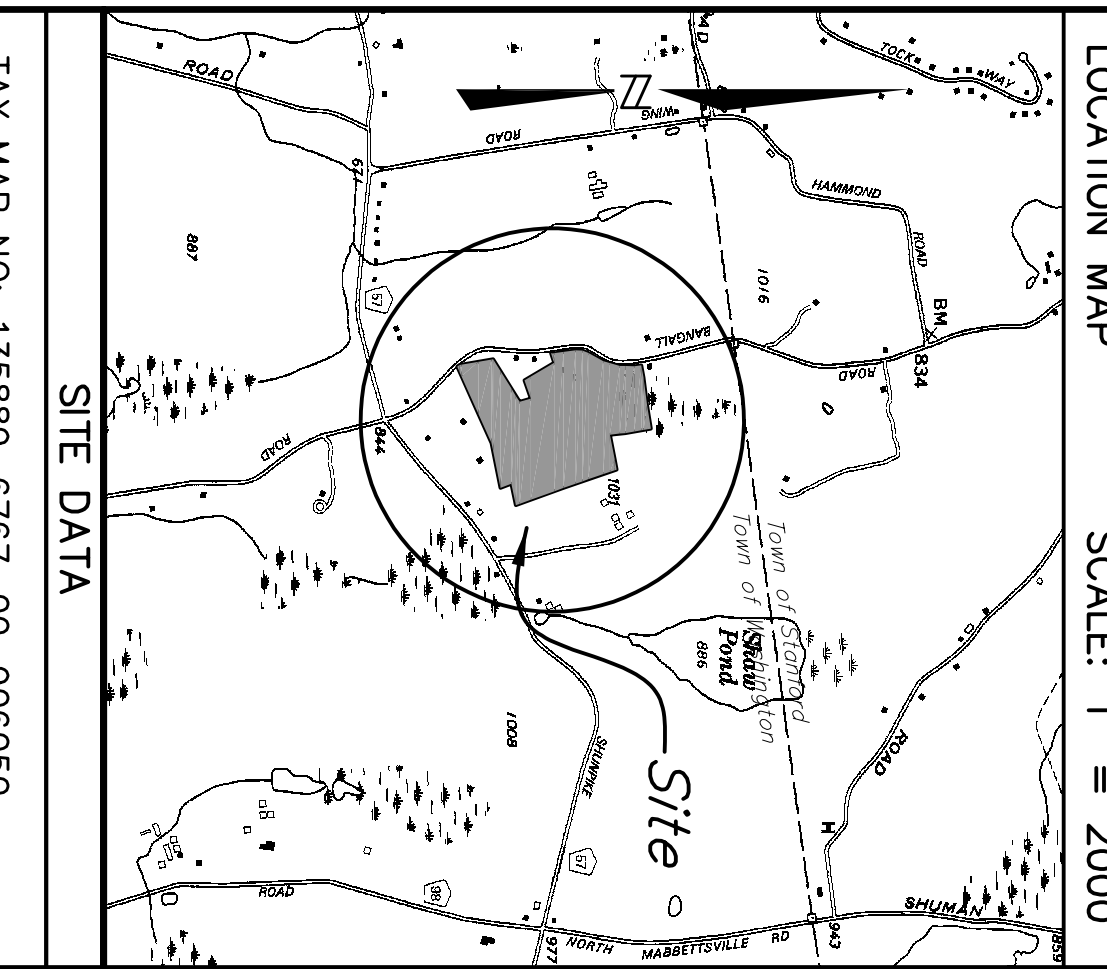

MAP NOTES

- Property line bearings and distances shown unless otherwise noted.
- The owner warrants that the boundaries shown on this map are true and correct.
- The owner warrants that the boundaries shown on this map are true and correct.
- The owner warrants that the boundaries shown on this map are true and correct.
- The owner warrants that the boundaries shown on this map are true and correct.

SOILS LEGEND

Map Symbol	Soil Name
DWD	DUTCHESS-CANTONAL member
GAB	GEORGETOWN silt loam, 3 to 8 % slopes
SC	PALEOKAL silt loam, 8 to 15 % slopes
SCd	PALEOKAL silt loam, 8 to 15 % slopes
Su	SuM silt loam

REVISIONS

DATE	DESCRIPTION
10/22/20	ORIGINAL DRAWING
01/13/21	HOUSE FOOTPRINT, BASEMENT SERVICES & PORCHES, BEDROOM, COAT, ELM DOOR & 2/23/21 DEVELOP RESIDENTIAL SITE PLAN
04/20/21	ADD STATE & FEDERAL WETLANDS, UPDATE PLAN WITH NEW SHAPES
05/03/21	ENHANCE THE APPROXIMATIONS ACCESS

WARNING STAMP

ATTENTION OF THIS DOCUMENT IN ANY WAY, BY ANY PERSON NOT UNDER THE EMBLEM OF A LICENSED SURVEYOR, AS APPROPRIATE, IS A VIOLATION OF THE EDUCATION LAW OF THE STATE OF NEW YORK.

PROJECT LOCATION

692-698 BANGALL ROAD, MILLBROOK TOWN OF WASHINGTON COUNTY OF DUTCHESS STATE OF NEW YORK

PROJECT DESCRIPTION

NEW CONSTRUCTION OF SINGLE-FAMILY RESIDENCE TO BE SERVED BY NEW INDIVIDUAL PRIVATE SEPTIC & WELL. THIS RESIDENCE SHALL BE A 2.5-ACRE RESIDENCE. THE RESIDENCE SHALL BE THE GUEST HOUSE.

PREPARED FOR

JESSE DENNIS & JORDANA KIER
WEST 20TH STREET - UNIT #11
NEW YORK, NY 10011

RESIDENTIAL SITE PLAN & DRIVEWAY PROFILE

STORMWATER POLLUTION PREVENTION PLAN (BASIS)

SCALE: AS NOTED

PRINTED

May 2, 2021

BADEY & WATSON
Surveying & Engineering, P.C.

447 201 1017
448 348 4241
877-3-1189 (TOLL FREE)

SHEET 2 OF 3

FILE NO. 20-107